

## ENTRY FORM - BLOCK CAPITALS PLEASE

Name .....Male/Female.....  
 Address.....  
 .....Post Code.....  
 Phone.....Club.....  
 ECF M/no.....Plat  Gold  Silver  Bronze   
 ECF Grading Reference no  
 (please tick above if a member).....  
 Grade.....Source.....

NB: Players without a grade must give details of their playing strength on a separate sheet.

EVENT	DESCRIPTION	TICK
1 Open	(Sat/Sun £42)	<input type="checkbox"/> £
2 Major	(Sat/Sun £39)	<input type="checkbox"/> £
3 Intermediate	(Sat/Sun £37)	<input type="checkbox"/> £
4 Minor	(Sat/Sun £35)	<input type="checkbox"/> £
5 England u/11 trial	(Sat only £23)	<input type="checkbox"/> £
6 Junior One Day	(Sat only £23)	<input type="checkbox"/> £
7 Brit. Jun. u/16 Rapidplay	(Sun only £23)	<input type="checkbox"/> £
8 Brit. Jun. u/12 Rapidplay	(Sun only £23)	<input type="checkbox"/> £
Pay on the day entry surcharge of £5/£10**	....	<input type="checkbox"/> £
Late entry surcharge (£10) <sup>†</sup>	.....	<input type="checkbox"/> £

(For entries on or after November 19th, 2012)

Optional Donation ..... £.....  
 ½ pt bye if required 1st round please tick ..... £.....

Byes for other rounds: advise controller on the day  
 Less ECF/discount if it applies<sup>‡‡</sup> ..... £.....

Direct debit  Cheque/P.O.  Cash .....Total £.....

### Please fill in/tick as appropriate below

Juniors - Date of birth: / /

Disabled -  Senior (before 1/09/52) -

<sup>‡‡</sup>Only ECF new platinum/gold/ silver members can deduct £6 for an Open /Major/Intermediate/Minor entry or deduct £5 for a Junior event entry.

### Join ECF /or upgrade

by emailing **S. Burton**.

Postal orders/cheques payable to **British Rapidplay**.

Address to S. Burton, The Treasurer, 4 Osbourne Court, Back Lane, Bramley, LS13 4BN. 0113 256 8157. Email: [sburtonchess@aol.com](mailto:sburtonchess@aol.com)

\*\*All pay on the day entries before November 19th will be surcharged £5. †All entries postmarked on or after Monday 19th November and by phone are subject to a £10 surcharge. No direct debit after Nov.19th. NMS scheme does not apply anymore, only new ECF.

## Saturday November 24th

### MAIN EVENT TIMES

Opening Ceremony 11.45am (Open/Major/Intermediate/Minor)

**Round 1.** 12.00 pm - 1.00 pm

**Round 2.** 1.30 pm - 2.30 pm

**Round 3.** 3.00 pm - 4.00 pm

**Round 4.** 4.30 pm - 5.30 pm

**Round 5.** 6.00 pm - 7.00 pm

**Round 6.** 7.30 pm - 8.30 pm

### Saturday Junior Events

#### 5 Rounds only

Start times: one hour per round  
 12.00pm, 1.30pm, 3.00pm, 4.30pm, 6pm

### Sunday November 25th

(Open/Major/Intermediate/Minor)

**Round 7.** 9.30 am - 10.30 am

**Round 8.** 11.00 am - 12.00 pm

**Round 9.** 12.45 pm - 1.45 pm

**Round 10.** 2.15 pm - 3.15 pm

**Round 11.** 3.45 pm - 4.45 pm

Sunday's Junior Events will be over 5 rounds and at the same start times as the main events.

### PRIZE GIVING CEREMONY 5.20pm

### RATE OF PLAY/DEFAULT RULES

Each player has thirty minutes to complete the Game. Rapidplay rules apply. E.C.F. default rules apply. A player arriving more than ten minutes late will be defaulted. Re-pairings will take place ten minutes after start of play.

### OTHER INFORMATION

Visit [www.british-rapidplay.org.uk](http://www.british-rapidplay.org.uk)

Contact – for all entries - Steve Burton Tel: (0113) 256 8157

Grading queries – please check out  
<http://grading.ecfservices.org.uk>

#### PAYMENTS FOR DIRECT DEBIT

A/C No. 00642367. S/C-30005 before November 19th.

Email: [sburtonchess@aol.com](mailto:sburtonchess@aol.com) to confirm.

# BRITISH RAPIDPLAY CHESS CHAMPIONSHIPS



Gandhi Hall, James Graham Building,  
 Leeds Metropolitan University,  
 Beckett's Park Campus,  
 Headingley LS6 3QS



Sat 24th / Sun 25th November 2012  
[www.wellmetconferencing.com](http://www.wellmetconferencing.com)



An English Chess Federation Supported  
 Grand Prix Event

Live coverage on the internet site  
[www.british-rapidplay.org.uk](http://www.british-rapidplay.org.uk)

## SENIOR EVENTS

### (1) THE OPEN CHAMPIONSHIP

Open to all players.  
Entry fee - £42

Prizes - £500, £250, £150, £75, £50 plus grading prizes.  
FREE ENTRY to GMs, IMs, WGMs and WIMs for entries received by 19th November.

### (2) THE MAJOR CHAMPIONSHIP

Open to players graded below 171  
Entry fee - £39

Prizes - £350, £175, £90, £60, £50 plus grading.

### (3) THE INTERMEDIATE CHAMPIONSHIP

Open to players graded below 146  
Entry fee - £37

Prizes - £320, £160, £80, £60, £50 plus grading prizes.

### (4) THE MINOR CHAMPIONSHIP

Open to players graded below 121  
Entry fee - £35

Prizes - £300, £150, £75, £60, £50 plus grading prizes.

## JUNIOR EVENTS

Saturday 24th

### (5) AN ENGLAND UNDER 11 TRIAL QUALIFIER

### (6) JUNIOR ONE DAY RAPIDPLAY\*\*\*

Sunday 25th

### (7) JUNIOR BRITISH RAPIDPLAY UNDER 16\*\*\*

### (8) JUNIOR BRITISH RAPIDPLAY UNDER 12

\*\*\*Age Limit: Under 16 on 31st Aug 2012.

Entry fee - £23 per junior event.

Selected cash/books/certificates/and medals will be given.  
The timetable for junior events may be varied at the discretion of the controllers.

**SMOKING IS NOT ALLOWED IN THE VENUE AND MOBILE PHONES MUST BE SWITCHED OFF DURING PLAY.**

Telephone: 0113 812 3165 to contact site security/porters office at the LMU for urgent messages only. Suitable attire, appearance, behaviour required.

## ACCOMMODATION

Arrangements/prices, etc. up to entrant to arrange.

### ASCOT GRANGE HOTEL ★★★

126-130 Otley Road, Headingley.  
Telephone: 0113 293 4444  
[www.ascotgrangehotel.com](http://www.ascotgrangehotel.com)

### THE VILLAGE HOTEL★★★★

With swimming pool, restaurant.  
[www.village-hotels.co.uk](http://www.village-hotels.co.uk)  
186 Otley Road. LS16 5PR. Telephone: 0844 980 8031

## GENERAL SCHEMATIC MAPS

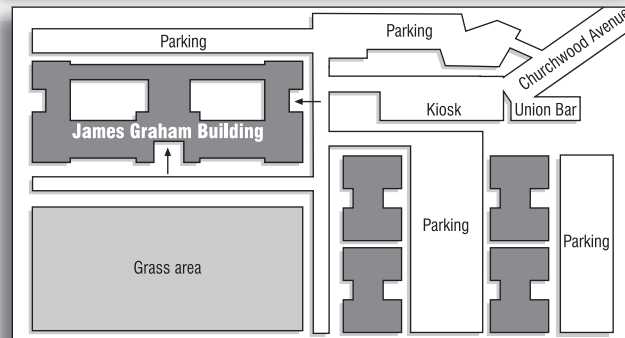
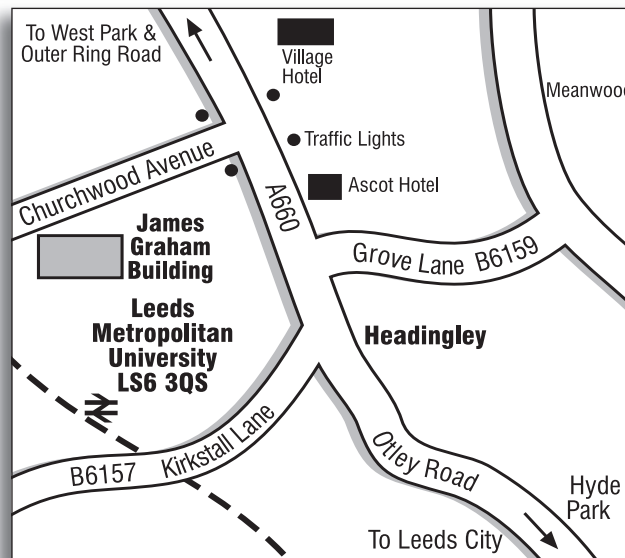

For general maps visit [www.googlemaps.com](http://www.googlemaps.com). For bus travel info visit [www.wymetro.com/BusTravel](http://www.wymetro.com/BusTravel). Note city bus from Leeds Railway or Bus station to Leeds Metropolitan University. Info/hotels etc. on Leeds visit. [www.leeds-uk.com](http://www.leeds-uk.com).

## BRITISH RAPIDPLAY 2012

Welcome to the 2012 British Rapidplay Chess Championship and back to Leeds Metropolitan University, Beckett's Park, Headingley, Leeds. Visit [www.leedsmet.ac.uk](http://www.leedsmet.ac.uk) for more info.

**PARKING** is free on both Saturday and Sunday. Events are in The Gandhi Hall (James Graham Building). And in The Jubilee Room. The Acre Room is for relaxing. Telephone 0113 812 3165 to contact site security/porters office.

## SOME KEY CHANGES FOR 2012

**ONLY NEW ECF MEMBERS ABOVE BRONZE GAIN REDUCTIONS.... UPGRADE/JOIN via S. Burton – [sburtonchess@aol.com](mailto:sburtonchess@aol.com)**

**PAY ON THE DAY ENTRIES WILL BE SURCHARGED. ENTRANTS/SECTION WILL BE AVAILABLE ON WEBSITE. PAYMENTS CAN BE MADE BY DIRECT DEBIT.**

## SOME OF LAST YEAR'S WINNERS

OPEN **GAWAIN JONES G.M.** MAJOR **ANDREW BAK**  
INTERMEDIATE **PAUL TALBOT** MINOR **GRAHAM BATES**  
ENGLAND UNDER 11 TRIAL **KOBY KALVANNAN**  
& **FRANCESCO BERNARDINI**

SATURDAY JUNIOR UNDER 16 **HARRY CROASDALE**  
SUNDAY JUNIOR UNDER 16 **ASHWIN KALYANA**  
SUN. JUNIOR UNDER 12 **ZHEMIN ZHANG/CALLUM BREWER**

## BOOKSTALL

The bookstall will be Courtesy of Chess Direct Ltd., PO Box 18, Mexborough, S64 9AR. Tel: (01709) 890 565.  
[www.chessdirect.co.uk](http://www.chessdirect.co.uk)

## SPECIAL NOTES

Sorry, but no ECF funding has been given again. The organizers reserve the right to increase or decrease the prizes dependent on the number of entries. Any adjustment will be announced prior to Round Six. It is important that if you are new scheme silver/gold/platinum ECF members, you might save a lot on fees. Contact Stephen Burton for details.

## CONTROLLERS

Congress Director – **David Welch**. Arbiters – **A.McFarlane, L. Barnes, P. Purland, G. Jones, R.Hart, I. Lewyk** and **N. Belinfante**. The controllers and administrators have the right to decline entries without liability. **Their decisions are final** in all chess match and grading disputes.

## REFRESHMENTS (Both Days)

Food Court opening times – Tiki (coffee bar) 10.00-15.00.  
Hot food counters – 12.00-14.30, Shop 10.00-16.00.  
Bacon sandwiches available to buy from 10 'til 11.15am.

## GRADING

ECF Rapidplay grades A to D take precedence. However, International, National, Local Gradings and recent British Rapidplay results may also be considered at our discretion. Players without a grade MUST give a detailed estimate of their strength. The event is E.C.F. game fee registered and all players games will be graded.