

SENIOR EVENTS

(1) THE OPEN CHAMPIONSHIP

Open to all players.

Entry fee - £42

Prizes - £600, £300, £150, £75, £50 plus grading prizes.

FREE ENTRY to GMs, IMs, WGMs and WIMs for entries received by 18th November.

(2) THE MAJOR CHAMPIONSHIP

Open to players graded below 171

Entry fee - £39

Prizes - £360, £180, £90, £60, £50 plus grading.

(3) THE INTERMEDIATE CHAMPIONSHIP

Open to players graded below 146

Entry fee - £37

Prizes - £340, £170, £85, £60, £50 plus grading prizes.

(4) THE MINOR CHAMPIONSHIP

Open to players graded below 121

Entry fee - £35

Prizes - £320, £160, £80, £60, £50 plus grading prizes.

JUNIOR EVENTS

Saturday 23rd

(5) AN ENGLAND UNDER 11 TRIAL QUALIFIER

Sunday 24th

(6) JUNIOR BRITISH RAPIDPLAY UNDER 16***

(7) JUNIOR BRITISH RAPIDPLAY UNDER 12

***Age Limit: Under 16 on 31st Aug 2013.

Entry fee - £21 per junior event.

Selected cash/books/certificates/and medals will be given. The timetable for junior events may be varied at the discretion of the controllers.

SMOKING IS NOT ALLOWED IN THE VENUE AND MOBILE PHONES MUST BE SWITCHED OFF DURING PLAY.

Telephone: 0113 812 3165 to contact site security/porters office at the LMU for urgent messages only. Suitable attire, appearance, behaviour required.

ACCOMMODATION

Arrangements/prices, etc. up to entrant to arrange.

ASCOT GRANGE HOTEL ***

126-130 Otley Road, Headingley.

Telephone: 0113 293 4444

www.ascotgrangehotel.com

THE VILLAGE HOTEL ****

With swimming pool, restaurant.

www.village-hotels.co.uk

186 Otley Road. LS16 5PR. Telephone: 0844 980 8031

GENERAL SCHEMATIC MAPS

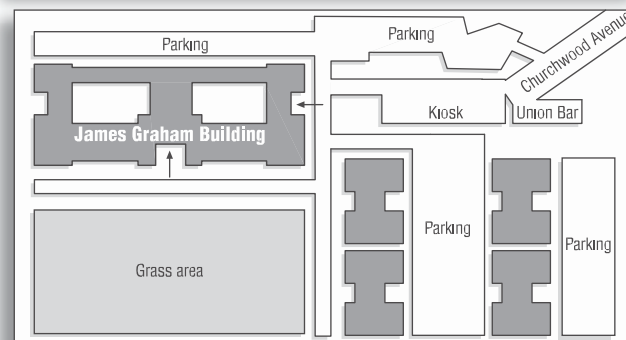
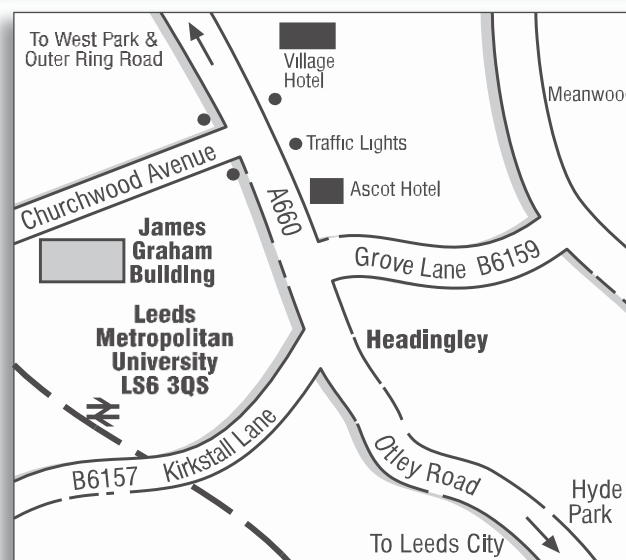

For general maps visit www.googlemaps.com For bus travel info visit www.wymetro.com/bustravel Note city bus from Leeds Railway or Bus Station to Leeds Metropolitan University. Info/hotels etc. on Leeds visit. www.leeds-uk.com

BRITISH RAPIDPLAY 2013

Welcome to the 2013 British Rapidplay Chess Championship and back to Leeds Metropolitan University, Beckett's Park, Headingley, Leeds. Visit www.leedsmet.ac.uk for more info.

PARKING is free on both Saturday and Sunday. Events are in The Great Hall (James Graham Building). And in The Jubilee Room. The Acre Room is for relaxing. Telephone 0113 812 3165 to contact site security/porters office.

SOME KEY CHANGES FOR 2013

ONLY NEW ECF MEMBERS ABOVE BRONZE GAIN REDUCTIONS....

UPGRADE/JOIN only via the ECF website

<http://www.englishchess.org.uk/>

PAY ON THE DAY ENTRIES WILL BE SURCHARGED. LOWER ENTRY FEES IN JUNIOR EVENTS PLUS SOME INCREASES IN PRIZE MONEY IN SENIOR EVENTS. PAYMENTS AVAILABLE BY BANK TRANSFER/ENTRANTS LIST AGAIN ON WEBSITE.

SOME OF LAST YEAR'S WINNERS

OPEN JONATHON HAWKINS I.M. MAJOR P.J. OLBISON
INTERMEDIATE M. MC DONAGH MINOR ANGELICA DEAN ENGLAND
UNDER 11 TRIAL MATTHEW FORSTER SATURDAY JUNIOR UNDER 16
HAMBEL WILLOW SUNDAY JUNIOR UNDER 16 STEPHEN CHUNG
SUN. JUNIOR UNDER 12 K.KALAVANNAN/J.BOSWELL LIAM REED

BOOKSTALL

The bookstall will be Courtesy of Chess Direct Ltd., PO Box 18, Mexborough, S64 9AR. Tel: (01709) 890 565.
www.chessdirect.co.uk

SPECIAL NOTES

Sorry, but no ECF funding has been given again. The organizers reserve the right to increase or decrease the prizes dependent on the number of entries. Any adjustment will be announced prior to Round Six. It is important that if you are new scheme silver/gold/platinum ECF members, you might save a lot on fees. Contact ECF for details.

CONTROLLERS

Congress Director – David Welch. Arbiters – A.McFarlane, L. Barnes, P. Purland, R. Hart, I. Lewyk, J. Hipshon and C. Bowler. The controllers and administrators have the right to decline entries without liability. **Their decisions are final** in all chess match and grading disputes.

REFRESHMENTS (Both Days)

Food Court opening times – Tiki (coffee bar) 10.00-15.00.
Hot food counters – 12.00-14.30, Shop 10.00-16.00.
Bacon sandwiches available to buy from 10 'til 11.15am.

GRADING

ECF Rapidplay grades A to D take precedence. However, International, National, Local Gradings and recent British Rapidplay results may also be considered at our discretion. Players without a grade **MUST** give a detailed estimate of their strength. The event is E.C.F. game fee registered and all players games will be graded.

ENTRY FORM - BLOCK CAPITALS PLEASE

NameMale/Female.....
 Address
Post Code
 PhoneClub
 ECF M/no.....Plat Gold Silver Bronze
 ECF Grading Reference no
 (please tick above if a member)
 Grade.....Source
 NB: Players without a grade must give comprehensive details of
 their playing strength on a separate sheet or risk refusal of
 entry.

EVENT	DESCRIPTION	TICK
1 Open	(Sat/Sun £42)	<input type="checkbox"/> £
2 Major	(Sat/Sun £39)	<input type="checkbox"/> £
3 Intermediate	(Sat/Sun £37)	<input type="checkbox"/> £
4 Minor	(Sat/Sun £35)	<input type="checkbox"/> £
5 England u/11 trial	(Sat only £21)	<input type="checkbox"/> £
6 Brit. Jun. u/16 Rapidplay	(Sun only £21)	<input type="checkbox"/> £
7 Brit. Jun. u/12 Rapidplay	(Sun only £21)	<input type="checkbox"/> £
Pay on the day entry surcharge	of £5/£10**	<input type="checkbox"/> £
Late entry surcharge	(£10) [†]	<input type="checkbox"/> £
(For entries on or after November 18th, 2013)		
Optional Donation		<input type="checkbox"/> £
½ pt bye if required 1st round please tick		<input type="checkbox"/> £
Byes for other rounds: advise controller on the day		
Less ECF/discount if it applies^{‡‡}		<input type="checkbox"/> £
Bank Transfer <input type="checkbox"/> Cheque/P.O. <input type="checkbox"/> Cash <input type="checkbox"/>		<input type="checkbox"/> Total £

Please fill in/tick as appropriate below

Juniors - Date of birth: / /

Disabled - Please contact the secretary with
 any special requirements

^{‡‡}Only ECF new platinum/gold/ silver members can deduct £6 for an Open
 /Major/Intermediate/Minor entry or deduct £5 for a Junior event entry.

Postal orders/cheques payable to **British Rapidplay**. Address to S.
 Burton, The Treasurer, 4 Osbourne Court, Back Lane, Bramley, LS13
 4BN. 0113 256 8157. Email: sburtonchess@aol.com

**All pay on the day entries before November 18th will be surcharged £5. †All
 entries postmarked on or after Monday 18th November and by phone are subject
 to a £10 surcharge. No bank transfers after Nov.18th. NMS scheme does not
 apply anymore, only new ECF.

Saturday November 23rd

MAIN EVENT TIMES

Opening Ceremony 11.45am (Open/Major/Intermediate/Minor)

- Round 1.** 12.00 pm - 1.00 pm
- Round 2.** 1.30 pm - 2.30 pm
- Round 3.** 3.00 pm - 4.00 pm
- Round 4.** 4.30 pm - 5.30 pm
- Round 5.** 6.00 pm - 7.00 pm
- Round 6.** 7.30 pm - 8.30 pm

Saturday Junior Event

5 Rounds only

Start times: one hour per round
 12.00pm, 1.30pm, 3.00pm, 4.30pm, 6pm

Sunday November 24th

(Open/Major/Intermediate/Minor)

- Round 7.** 9.30 am - 10.30 am
- Round 8.** 11.00 am - 12.00 pm
- Round 9.** 12.45 pm - 1.45 pm
- Round 10.** 2.15 pm - 3.15 pm
- Round 11.** 3.45 pm - 4.45 pm

Sunday's Junior Events will be over 5 rounds and at the same
 start times as the main events.

PRIZE GIVING CEREMONY 5.20pm

RATE OF PLAY/DEFAULT RULES

Each player has thirty minutes to complete the Game. Rapidplay
 rules apply. E.C.F. default rules apply. A player arriving more than
 ten minutes late will be defaulted. Re-pairings will take place ten
 minutes after start of play.

OTHER INFORMATION

Visit www.british-rapidplay.org.uk

Contact – for all entries - Steve Burton **Tel: (0113) 256 8157**

Grading queries – please check out
<http://grading.ecfservices.org.uk>

PAYMENTS BY BANK TRANSFER

A/C No. 00642367. S/C-30-00-05 before November
 18th.

Email: sburtonchess@aol.com to confirm.

BRITISH RAPIDPLAY CHESS CHAMPIONSHIPS



Great Hall, James Graham Building,
 Leeds Metropolitan University,
 Beckett's Park Campus, Headingley
 LS6 3QS



Sat 23rd / Sun 24th November 2013
www.wellmetconferencing.com



An English Chess Federation Supported
 Grand Prix Event

Live coverage on the internet site
www.british-rapidplay.org.uk